

B.P. ISSUES DE SECOURS ET DE SERVICE

2V - ACOUSTIQUE 36 / AEV / THERMIQUE - BATTANTE NON FEU

Référence Commerciale : M102LSA36

MTI-121

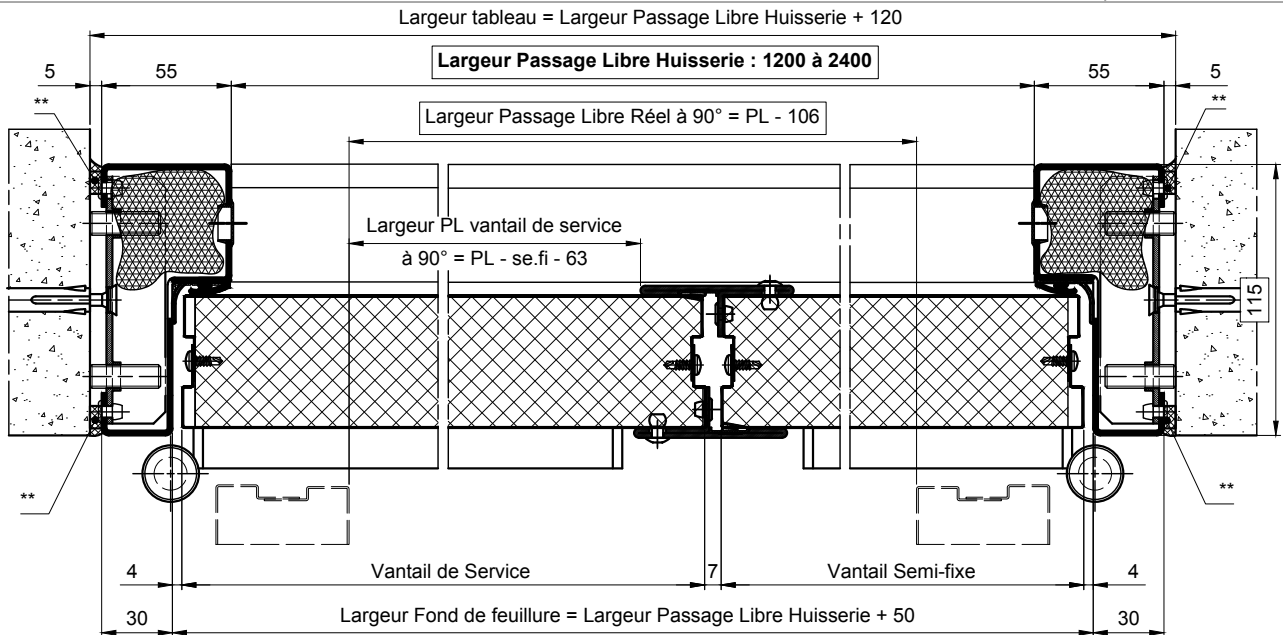

** : Mastic d'étanchéité sur fond de joint

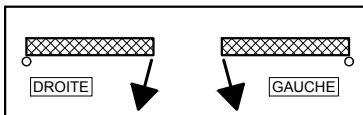

Protection en Partie haute sur 150 mini OBLIGATOIRE (Voir détail et option)

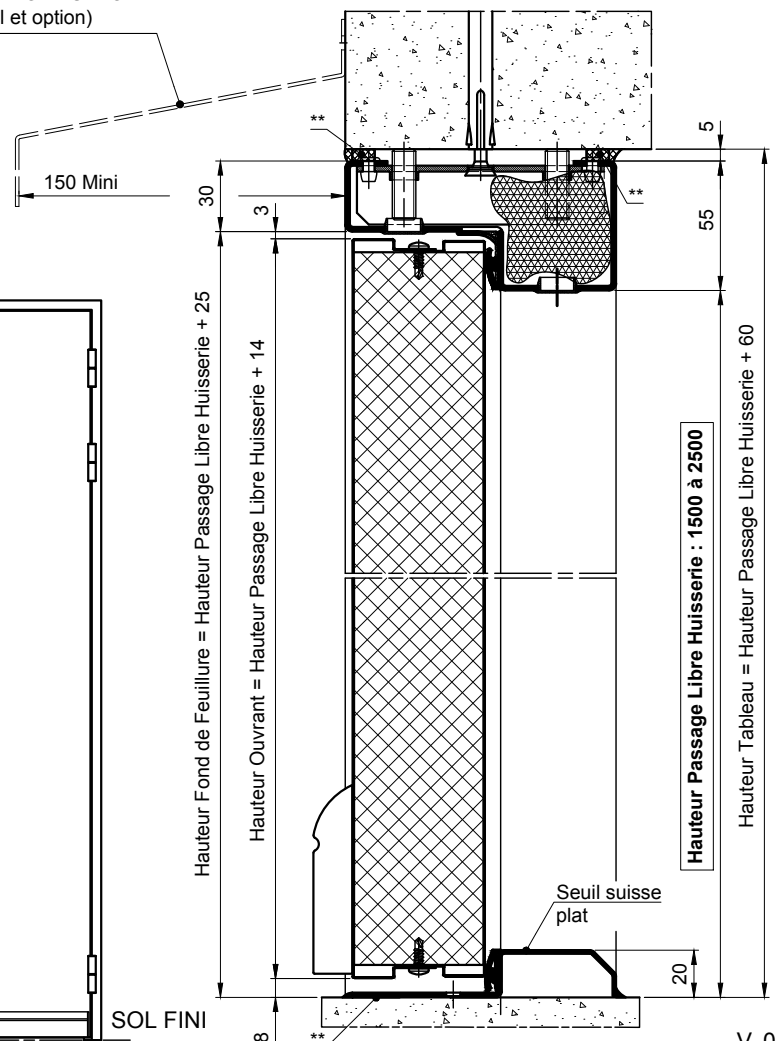
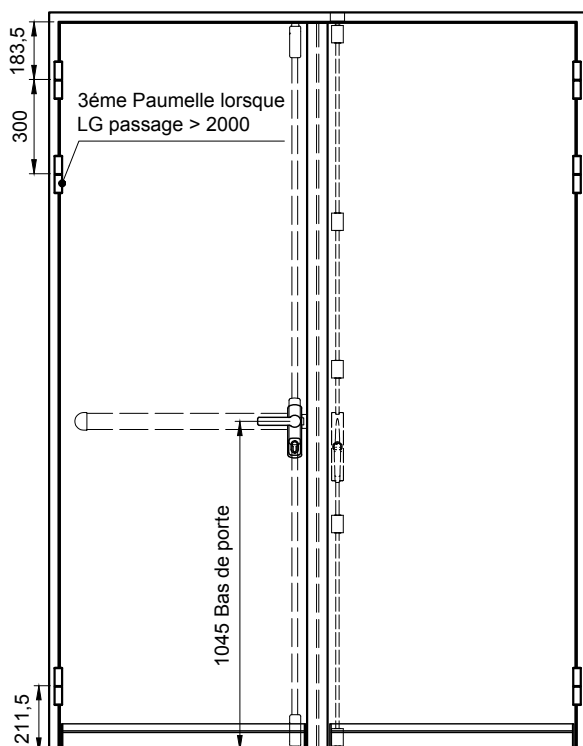
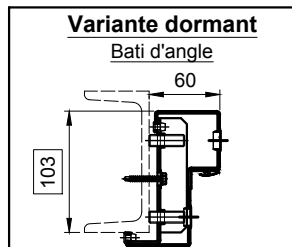

V-0